

## The basics.

When first using your Chameleon Pens™, the Super Soft Brush Nib might seem slightly hard and appear pointed (Fig. 1a) but in use, it will quickly soften. Once this natural “breaking in process” is complete, the fibers at the end of the nib will loosen and splay a little. (Fig. 1b) This is normal and allows it to perform more like a paintbrush.

**Important:** The Brush Nib is delicate – so for extended nib life be light-handed when coloring. In the event you damage either nib don't worry, they're inexpensive and easy to replace.

**Nibs:** Your Chameleon Pens™ are double-ended with a Japanese Bullet Nib at one end and a Super Soft Brush Nib at the other - both can be infused and are easily replaceable.

**Bullet Nib** - (Fig. 1c) Firm nib, great for outlining, drawing and working in small areas with precision coloring. The Bullet Nib is very durable.

**Super Soft Brush Nib** - (Fig. 1d) The Brush Nib has a ‘paintbrush’ feel. Its soft fibrous structure allows ink to flow beautifully across paper for bigger color gradations. The Brush Nib is super soft - so for longer life, be light-handed.

All the nibs in the Chameleon System are replaceable! (Fig. 1e) Chameleon Pens contain permanent alcohol inks and both the pens and the mixing chamber are completely refillable (Fig. 1f) To see how simple step-by-step videos on how to replace nibs and refill inks go to:

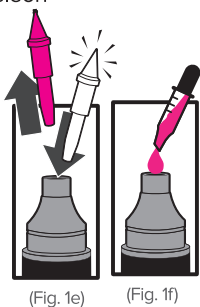

CHAMELEONARTPRODUCTS.COM

# One pen, three great ways to use!

## ① Color!

Chameleon Pens™ innovative system starts with a high-quality artist marker pen that can be used like other marker pens and is a great pen for all your creative projects!

The highly pigmented alcohol inks are quick drying and flow beautifully to give you smooth, flawless color lay down. (Fig. 2a)



The inks are designed to layer and blend so you can create more intense colors by layering the same color. (Fig. 2b)



Plus you can create all new colors by layering 2 different colors! (Fig. 2c)



## ② Color gradations!

Create depth, dimension, gradients, highlights, shading and shadows using Chameleon Pens™ with the mixing chamber.



- 1 Hold the pen in a vertical position. Gently place the Mixing Chamber onto the Brush Nib – the two Nibs will touch. (Fig. 3a)
- 2 Keeping the pen in a vertical position, hold and fuse for 15 seconds. (Fig. 3b)
- 3 Remove the pen from the Mixing Chamber. (Fig. 3c)
- 4 Color in a side-to-side motion, slightly overlapping the previous line, all the way to the edges of the image, working from light to dark for a seamless blend. (Fig. 3d)

**IMPORTANT:** The Mixing Chamber should always be on top of the pen when fusing. Never leave the pen engaged in the Mixing Chamber, always put caps back on before storing.

## ③ Color blends!

Create color to color blends using Chameleon Color Tops™\*



- 1 Hold the pen in a vertical position. Gently place the Color Top onto the Brush Nib – the two Nibs will touch. (Fig. 4a)
- 2 Keeping the pen in a vertical position, hold and fuse for 15 seconds. (Fig. 4b)
- 3 Remove the pen from the Color Top. (Fig. 4c)
- 4 Color in a side-to-side motion, slightly overlapping the previous line, all the way to the edges of the image, working from light to dark for a seamless blend. (Fig. 4d)

**IMPORTANT:** The Color Top should always be on top of the pen when fusing. Never leave the pen engaged in the Mixing Chamber, always put caps back on before storing.

\* Colors and contents may vary. Chameleon Color Tops™ may or may not be included in your kit.